

ASFA S hose clamps fitted with stainless steel inner-rings were designed to give extra protection to the hose, especially where vibration over long periods of time is an issue.

These clamps are particularly recommended for use on silicone hoses, which can be easily cut. The inner-ring fitted to the ASFA clamp prevents damage to the hose, as well as distributing the pressure of the clamp evenly around the hose. The black finish is ideal for applications where the clamp is required to blend in with the rest of the assembly.

* The maximum application pressure can vary depending on the type of hose and the geometry of the coupling.

MATERIAL: W1 Galvanized steel
DIN 1.0935
Bolt: Steel Qst 36-3
DIN 1.0214
Inner-ring: Stainless steel
AISI 301 DIN 1.4310

FINISH: Clamp: Black Delta Seal
Inner-ring: Black tefloned

CORROSION RESISTANCE: 144 hours salt spray
(ASTM B-117)

Ø D Application +2	Part Number	L +1-0.5	T ±0.1	H Max.	B Max.	S Min.	Max. Pressure Bar	Box Quantity	Outer Box Quantity
16-27	AT009001	29,6	0,85	11	16,7	19,5	45	50	50
20-32	AT009002	29,6	0,85	11	16,7	19,5	45	50	50
25-40	AT009003	29,6	0,85	11	16,7	19,5	40	50	50
30-45	AT009004	29,6	0,85	11	16,7	19,5	35	50	50
32-50	AT009005	29,6	0,85	11	16,7	19,5	35	50	50
40-60	AT009006	29,6	0,85	11	16,7	19,5	30	50	50
50-70	AT009007	29,6	0,85	11	16,7	19,5	25	50	50
60-80	AT009008	29,6	0,85	11	16,7	19,5	20	50	50
70-90	AT009009	29,6	0,85	11	16,7	19,5	17	50	50
80-100	AT009010	29,6	0,85	11	16,7	19,5	14	25	25

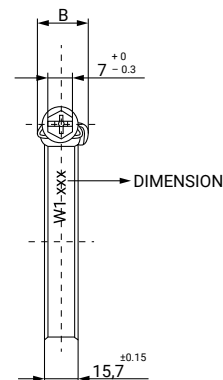
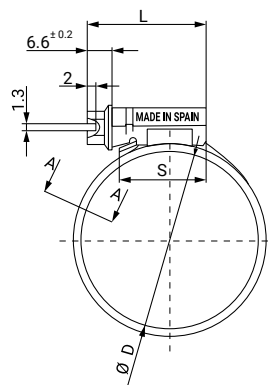
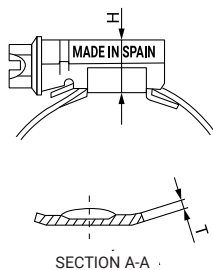

$\varnothing D$ Application +2	Part Number	L +1-0.5	T ± 0.1	H Max.	B Max.	S Min.	Max. Pressure Bar	Box Quantity	Outer Box Quantity
90-110	AT009011	29,6	0,85	11	16,7	19,5	12	25	25
100-120	AT009012	29,6	0,85	11	16,7	19,5	10	25	25
110-130	AT009013	29,6	0,85	11	16,7	19,5	8	25	25
120-140	AT009014	29,6	0,85	11	16,7	19,5	7	25	25
130-150	AT009015	31,6	0,85	11	16,7	21,5	6	25	25
140-160	AT009016	31,6	0,85	11	16,7	21,5	5	25	25
150-170	AT009017	31,6	0,85	11	16,7	21,5	4	25	25
160-180	AT009018	31,6	0,85	11	16,7	21,5	3	25	25
170-190	AT009019	31,6	0,85	11	16,7	21,5	2	10	10
180-200	AT009020	31,6	0,85	11	16,7	21,5	1,8	10	10
190-210	AT009021	31,6	0,85	11	16,7	21,5	1,8	10	10
200-220	AT009022	31,6	0,85	11	16,7	21,5	1,8	10	10
210-230	AT009023	31,6	0,85	11	16,7	21,5	1,6	10	10
220-240	AT009024	31,6	0,85	11	16,7	21,5	1,6	10	10